



Instruction Manual

Super 88

Model No. 2488, 2489, 2488EX, 2489EX







GOLD MEDAL[®] PRODUCTS CO.



10700 Medallion Drive, Cincinnati, Ohio 45241-4807 USA







SAFETY PRECAUTIONS

	 DANGER
	<p>Machine must be properly grounded to prevent electrical shock to personnel. Failure to do so could result in serious injury, or death. DO NOT immerse any part of this equipment in water. DO NOT use excessive water when cleaning. Keep cord and plug off the ground and away from moisture. Always unplug the equipment before cleaning or servicing. Make sure all machine switches are in the OFF position before plugging the equipment into the receptacle.</p> <p style="text-align: right; font-size: small;">008_051514</p>

	 DANGER
	<p>Improper installation, adjustment, alteration, service, or maintenance can cause property damage, injury, or death. Any alterations to this equipment will void the warranty and may cause a dangerous condition. NEVER make alterations to this equipment. Read the Installation, Operating, and Maintenance Instructions thoroughly before installing, servicing, or operating this equipment.</p> <p style="text-align: right; font-size: small;">014_051514</p>

	 WARNING
	<p>To avoid burns, DO NOT touch the kettle or any heated surface. DO NOT place or leave objects in contact with heated surfaces.</p> <p style="text-align: right; font-size: small;">013_092414</p>

	 WARNING
	<p>ALWAYS wear safety glasses when servicing this equipment.</p> <p style="text-align: right; font-size: small;">010_010914</p>

	 WARNING
	<p>No user serviceable parts inside. Refer servicing to qualified service personnel.</p> <p style="text-align: right; font-size: small;">011_051514</p>

	 WARNING
	<p>Read and understand operator's manual and all other safety instructions before using this equipment. To order copies of the operator's manual go to gmpopcorn.com or write to Gold Medal Products Co., 10700 Medallion Drive, Cincinnati, OH 45241 USA 1-(800)-543-0862</p> <p style="text-align: right; font-size: small;">022_060215</p>



SAFETY PRECAUTIONS (continued)

	WARNING
	<p>DO NOT allow direct contact of this equipment by the public when used in food service locations. Only personnel trained and experienced in the equipment operation may operate this equipment. Carefully read all instructions before operation.</p> <p style="text-align: right; font-size: small;">012_010914</p>

	WARNING
	<p>This machine is NOT to be operated by minors.</p> <p style="text-align: right; font-size: small;">007_010914</p>

Note: Improvements are always being made to Gold Medal’s equipment. This information may not be the latest available for your purposes. It is critical that you call Gold Medal’s Technical Service Department at 1-800-543-0862 for any questions about your machine operations, replacement parts, or any service questions. (Gold Medal Products Co. does not assume any liability for injury due to careless handling and/or reckless operation of this equipment.)



INSTALLATION INSTRUCTIONS

Inspection of Shipment

After unpacking, check thoroughly for any damage which may have occurred in transit. Claims should be filed immediately with the transportation company. The warranty does not cover damage that occurs in transit, or damage caused by abuse, or consequential damage due to the operation of this machine, since it is beyond our control.

Setup

Your new Popper was assembled and tested at the factory. Remove all packing material and tape before starting operation.

Accessories Included With Your Machine

- Corn Measure Cup
- Flavacol Cup
- Stamped Aluminum Scoop
- Oil Measure Cup.

Electrical Requirements

The following power supply must be provided for your machine:

2488: 120V, 1525W, 60Hz

2489: 120V, 1605W, 60Hz

2488EX: 230V, 1562W, 50Hz

2489EX: 230V, 1570W, 50Hz

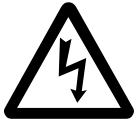
⚠ DANGER	
	<p>Machine must be properly grounded to prevent electrical shock to personnel. Failure to do so could result in serious injury, or death.</p> <p>Do NOT immerse any part of this equipment in water.</p> <p>Do NOT use excessive water when cleaning.</p> <p>Keep cord and plug off the ground and away from moisture.</p> <p>Always unplug the equipment before cleaning or servicing.</p>

Your electrician must furnish sufficient power for proper machine operation. We recommend this popper be on a dedicated and protected circuit. Failure to wire properly will void the warranty and may result in damage to the machine. It is Gold Medal Products Company's recommendation that this machine be plugged directly into a wall outlet. The use of extension cords is not recommended due to safety concerns, and may cause sacrificed and/or reduced performance.

Before You Plug In Machine

1. Make sure all machine switches are in the OFF position before plugging the equipment into the receptacle.
2. Make sure the wall outlet can accept the grounded plugs (where applicable) on the power supply cord.
3. The wall outlet must have the proper polarity. If in doubt, have a competent electrician inspect the outlet and correct if necessary.
4. **DO NOT** use a grounded to un-grounded receptacle adapter.
5. Install the unit in a level position.

OPERATING INSTRUCTIONS

Controls and their Functions

LIGHT AND WARMER SWITCH

Turns on the heat to the bottom corn pan and heat light.

KETTLE MOTOR SWITCH

Turns on the motor which drives the kettle agitator.

KETTLE HEAT SWITCH

Supplies power to the thermostat controlled kettle.

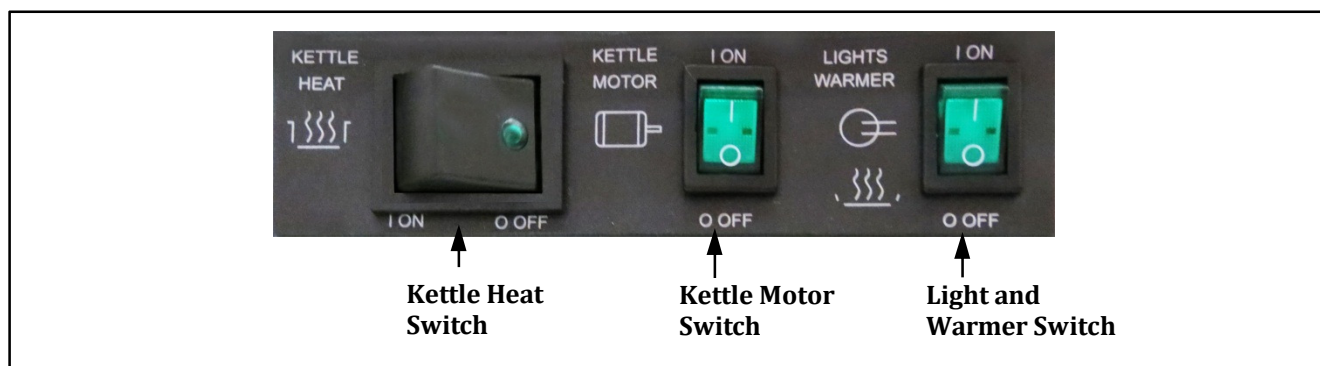

Amount of Popcorn and Oil

Your new Popper is equipped with a corn measuring cup. Popcorn popped in coconut oil stays fresher longer. Coconut oil does not leave black deposits in your kettle like other oils.

Corn charge – 8.0 oz.



Oil charge – 2.0 oz.



Flavacol – 1 tablespoon

Popping Instructions

1. Turn the Kettle Heat and Kettle Motor Switch on.
2. Make a test pop with 3 kernels of corn and 2.0 oz. of oil.
3. Turn on the kettle and let it pre-heat for 5 to 8 minutes.
4. Load pre-measured popcorn and oil into kettle.
5. When corn has finished popping, dump the kettle.
6. Repeat cycle starting with #4.
7. Turn kettle heat and motor off when finished popping corn.

Care and Cleaning

	 DANGER
	<p>Machine must be properly grounded to prevent electrical shock to personnel. DO NOT immerse in water. Always unplug the equipment before cleaning or servicing.</p> <p style="text-align: right; font-size: small;">025_020314</p>

	 WARNING
	<p>To avoid serious burns, DO NOT touch the kettle while it is hot!</p> <p style="text-align: right; font-size: small;">028_082715</p>

Good sanitation practice demands that all food preparation equipment be cleaned regularly (only use non-toxic, food grade cleaners). A clean looking, well-kept machine is one of the best ways of advertising your product.

Note: It is extremely important to follow all of the cleaning procedures, otherwise parts damage and equipment failure will result. The warranty does not cover parts that are damaged due to improper cleaning.

Daily Kettle Cleaning Instructions

CAUTION: A hot kettle will cause burns if you touch it with your hand. Allow kettle to cool at least 1 hour before attempting to clean. **DO NOT** use ice or water to cool down a hot kettle! Severe kettle damage will result!

1. When cool, wipe the **outside** of the kettle with a clean, soft cloth. **DO NOT** use oven cleaners or abrasive materials as they will damage the kettle.
2. Every night, mix Gold Medal's Heat'n Kleen solution (Item No. 2095), 2 tablespoons per gallon of water. It is not necessary to use the entire gallon at once; only use enough to fill the kettle 1/2 inch deep.
3. Turn the kettle heat ON. When the water starts to boil, turn the kettle heat OFF.
4. Allow to cool for at least 1 hour, then dump the solution into a bucket and wipe the inside of the kettle with a clean cloth. Make sure all of the solution goes into the bucket; do not spill any in the interior of the machine.

For extra dirty kettles, the process may be repeated; or, after turning the kettle heat OFF, allow solution to sit in the kettle overnight. The next morning, dump the solution into a bucket and wipe the inside of the kettle with a clean cloth.

5. With the unit OFF and unplugged, wipe the kettle lead cord with a clean SLIGHTLY damp cloth. **DO NOT get moisture into the kettle lead-in cord, severe damage will result.**



Daily Unit Cleaning Instructions

1. With the machine OFF, unplug the unit and allow it to cool before attempting to clean.
2. Make sure to clean all pans/accessories in order to sanitize them before each use.
3. Take a clean, SLIGHTLY damp cloth and wipe excess grease from the glass and cabinet.
4. Wipe the stainless steel parts with a clean cloth and cleaner designed for stainless steel, such as Gold Medal Watchdog Stainless Cleaner (Item No. 2088).

DO NOT use oven cleaners or abrasive materials as they will damage parts of the machine.

5. Clean the glass panels with glass cleaner. Gold Medal Watchdog Glass Cleaner (Item No. 2588) is recommended.

Ammonia cleaners will damage the plastic doors. Use only non-ammonia cleaners, such as Gold Medal Watchdog Glass Cleaner (Item No. 2588).



MAINTENANCE INSTRUCTION

	⚠ DANGER
	Improper installation, adjustment, alteration, service, or maintenance can cause property damage, injury or death. Read the installation, Operating, and Maintenance Instructions thoroughly before installing or servicing this equipment.

	⚠ DANGER
	Do Not immerse the equipment in water. Unplug your machine before servicing.

	⚠ WARNING
	Adequate eye protection must be used when servicing this equipment to prevent eye injury.

	⚠ CAUTION
	THE FOLLOWING SECTIONS OF THIS MANUAL ARE INTENDED ONLY FOR QUALIFIED SERVICE PERSONNEL WHO ARE FAMILIAR WITH ELECTRICAL EQUIPMENT. THESE ARE NOT INTENDED FOR THE OPERATOR.



ORDERING SPARE PARTS

1. Identify the needed part by checking it against the photos, illustrations, and/or parts list.
2. When ordering, please include part number, part name, and quantity needed.
3. Please include your model number, serial number, and date of manufacture (located on the machine nameplate) with your order.
4. Address all parts orders to:

Parts Department
Gold Medal Products Co.
10700 Medallion Drive
Cincinnati, Ohio 45241-4807

Or, place orders by phone or online:

Phone: (800) 543-0862
(513) 769-7676

Fax: (800) 542-1496
(513) 769-8500

E-mail: info@gmpopcorn.com

Web Page: www.gmpopcorn.com



8 oz. Kettle Assembly – 61054N

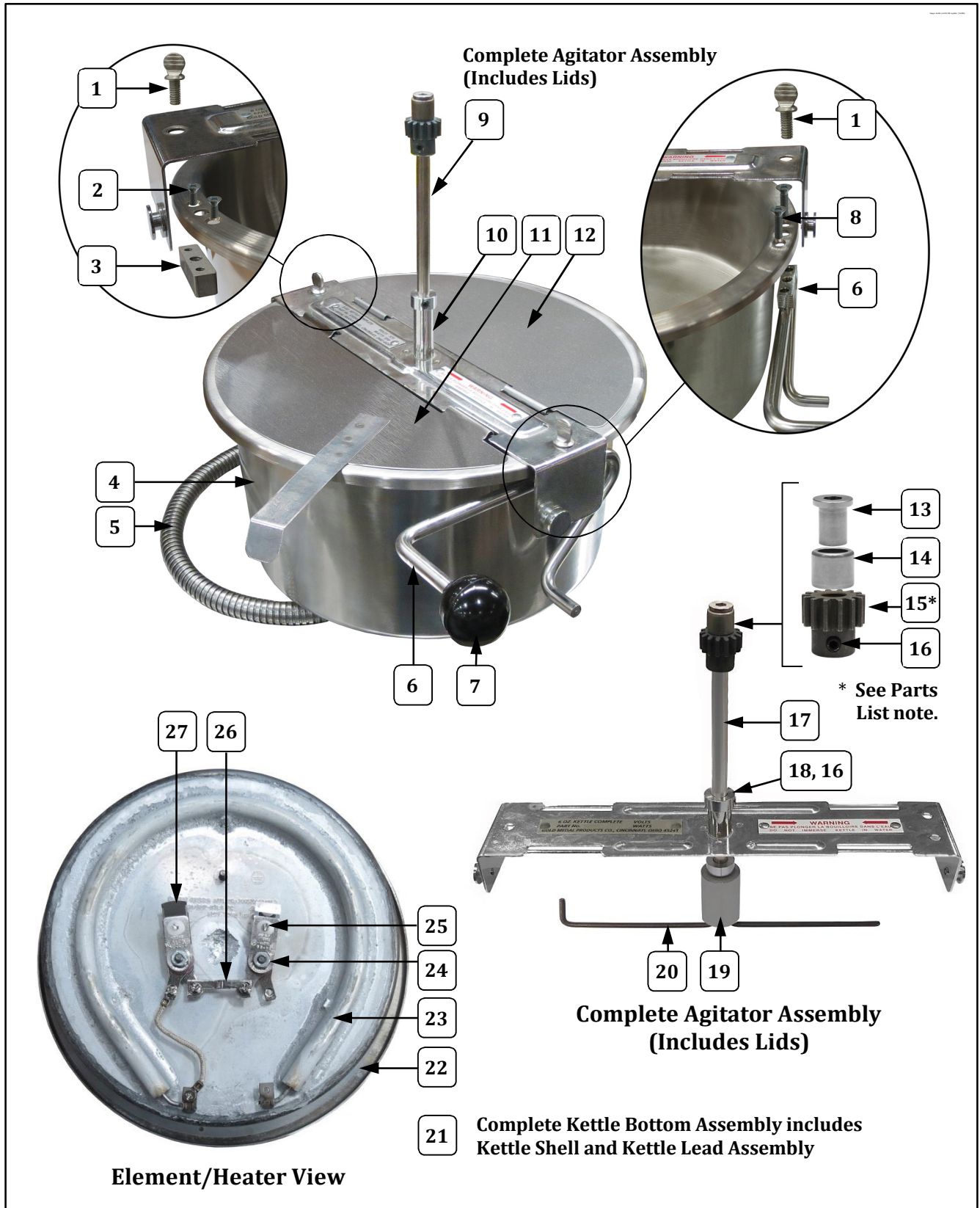



8 oz. Kettle Assembly – 61054N Parts List

Item	Part Description	Part No.
		61054N
1	1/4-20 X 1/2 THUMB SCREW	61059
2	8-32X3/8 FL HD PH MS	20065
3	KETTLE & SHELL BLOCK	61013
4	8 OZ. KETTLE SHELL	61017
5	KETTLE LEAD ASSEMBLY	61226
6	DUMP HANDLE - BLOCK WELDMENT	88769
7	DUMP HANDLE KNOB	47110
8	8-32X1 FL HD PH MS	20068
9	LID & AGITATOR ASSY (Complete Assembly)	61055N
10	KETTLE CROSSBAR ASSEMBLY	61010
11	FRONT KETTLE LID	47720
12	REAR KETTLE LID	47119
13	AGITATOR BEARING HUB	43434
14	NEEDLE BEARING	47106
15*	SPUR GEAR KIT (Includes 2 gears with set screws. Always replace Agitator Spur Gear and Kettle Drive Motor Gear as a set.)	47059K
16	SET SCREW #10-32 X 3/16	41742
17	12/14 OZ. AGITATOR SHAFT	69712
18	SET COLLAR 5/16 ID 5/8 OD	46649
19	AGITATOR WEIGHT	69715
20	6 OZ. STIR ROD	69714
Kettle Bottom Assembly - Element/Heater View		
21	8 OZ. KETTLE BOTTOM ASSEMBLY	61057N
22	8 OZ. KETTLE GASKET	61012
23	8 OZ. KETTLE & ELEMENT	61280
24	8-32 TOP LOCK NUT (where used, always replace lock nut if removed)	67943
25	482°F THERMOSTAT (Two 6-32 X 3/16 Screws Included each)	76708
26	THERMOSTAT SHUNT BAR	47193
27	550°F THERMOSTAT (Two 6-32 X 3/16 Screws Included each)	77108



8 oz. Kettle Assembly – 61054EX

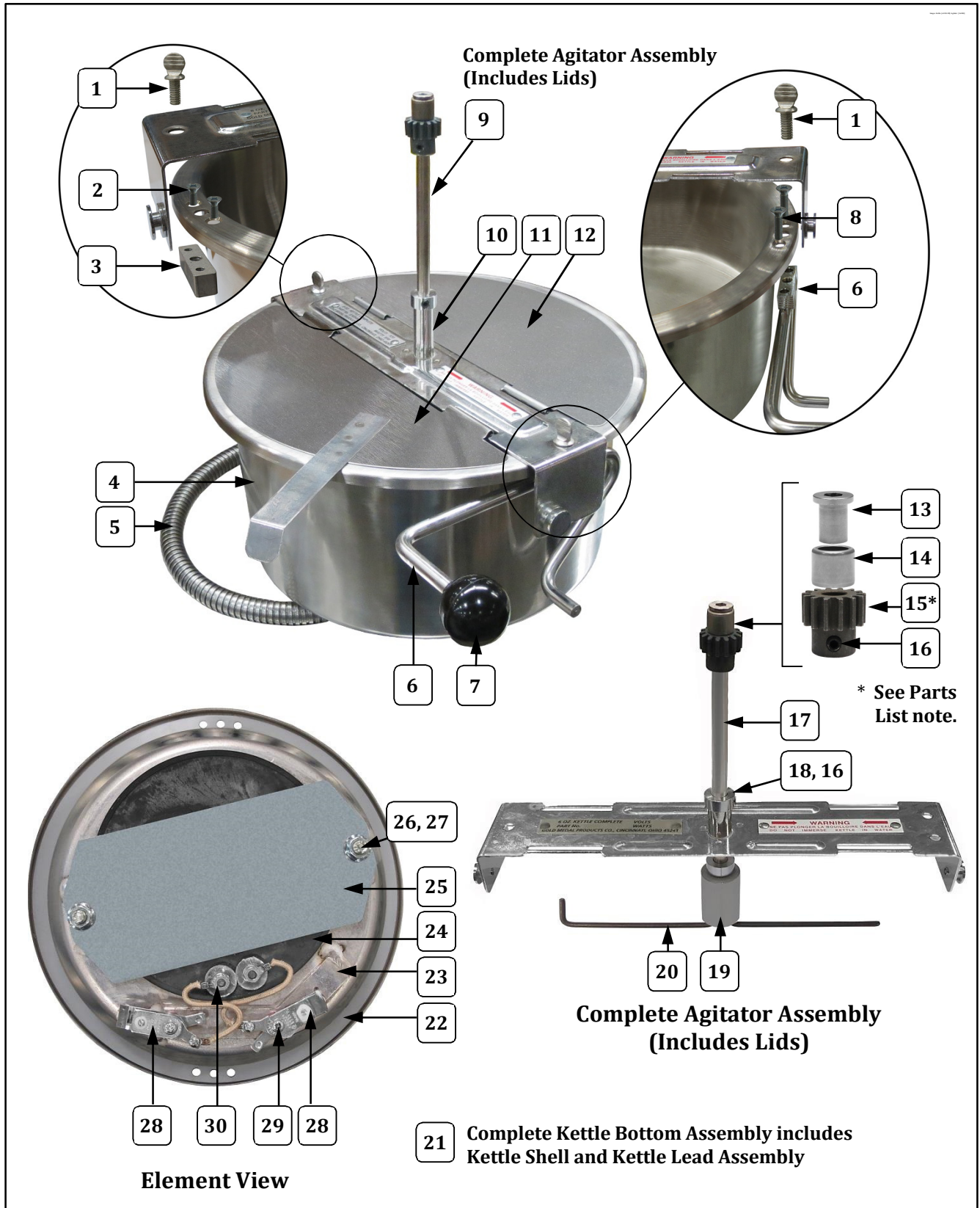



8 oz. SS Kettle Assembly – 61054EX Parts List

Item	Part Description	Part No.
		61054EX
1	1/4-20 X 1/2 THUMB SCREW	61059
2	8-32X3/8 FL HD PH MS	20065
3	KETTLE & SHELL BLOCK	61013
4	8 OZ. KETTLE SHELL	61017
5	EXPORT KETTLE LEAD ASSEMBLY	61227
6	DUMP HANDLE - BLOCK WELDMENT	88769
7	DUMP HANDLE KNOB	47110
8	8-32X1 FL HD PH MS	20068
9	LID & AGITATOR ASSY (Complete Assembly)	61055EX
10	KETTLE CROSSBAR ASSEMBLY	61010EX
11	FRONT KETTLE LID	47720
12	REAR KETTLE LID	47119
13	AGITATOR BEARING HUB	43434
14	NEEDLE BEARING	47106
15*	SPUR GEAR KIT (Includes 2 gears with set screws. Always replace Agitator Spur Gear and Kettle Drive Motor Gear as a set.)	47059K
16	SET SCREW #10-32 X 3/16	41742
17	12/14 OZ. AGITATOR SHAFT	69712
18	SET COLLAR 5/16 ID 5/8 OD	46649
19	AGITATOR WEIGHT	69715
20	6 OZ. STIR ROD	69714
Kettle Bottom Assembly - Element View		
21	8 OZ. KETTLE BOTTOM ASSEMBLY	61057EX
22	8 OZ. KETTLE GASKET	61012
23	8 OZ. KETTLE WELDMENT	61019
24	240 VOLT 1350 WATT HEAT ELEMENT	47672
25	ELEMENT RETAINER BRACKET	49310
26	5/16 - 18 X 3/4 SQUARE HEAD	49446
27	5/16 - 18 SERRATED LOCK NUT	49317
28	450°F THERMOSTAT (Two 6-32 X 3/8 Screws Included)	76089
29	8-32 TOP LOCK NUT (where used, always replace lock nut if removed)	67943

Cabinet Breakdown - Exterior

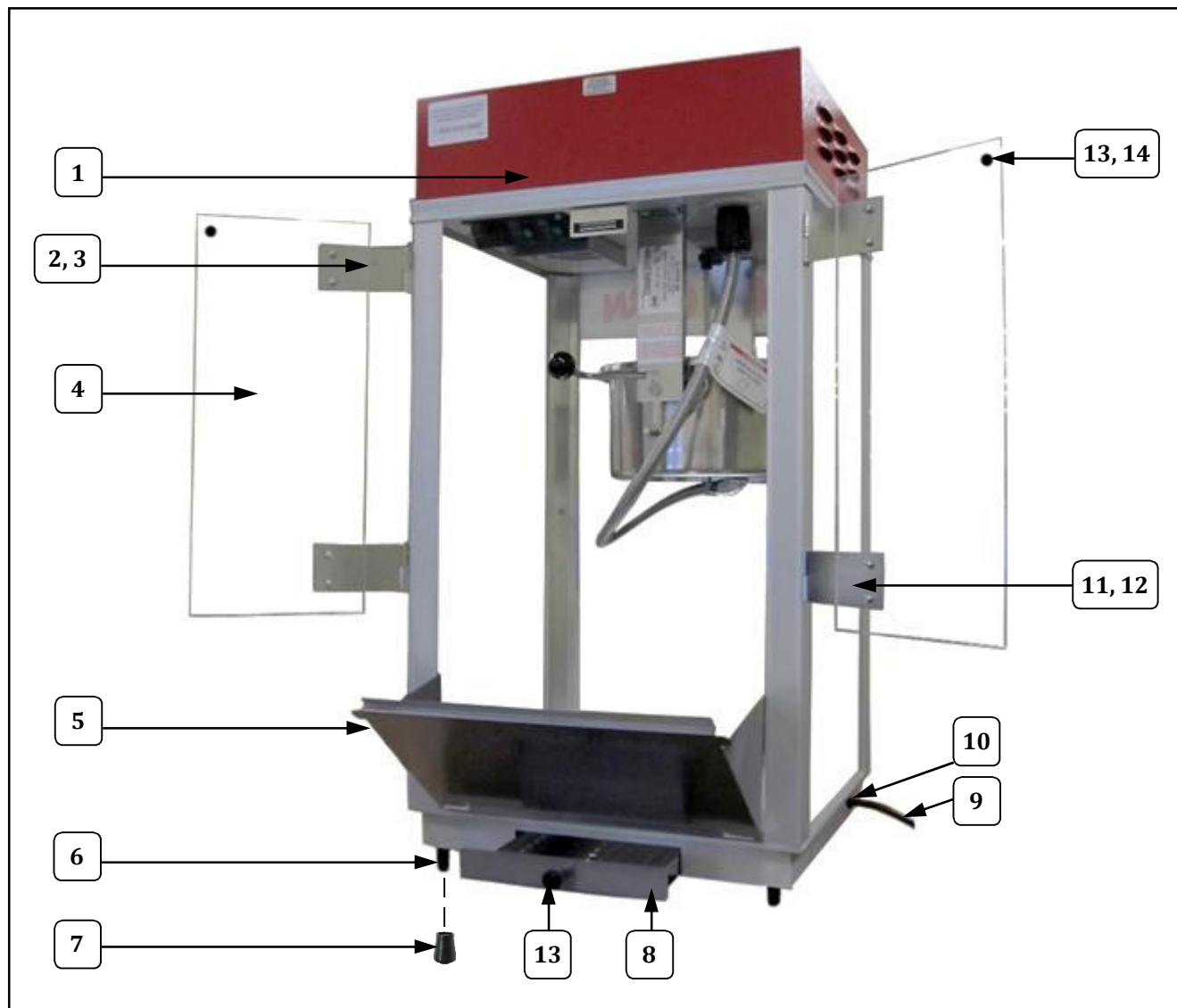

Item	Part Description	Qty.	Part Number			
			2488	2489	2488EX	2489EX
1	DOME RED	1	49456	59065	49456	59065
2	MALE HINGE SHORT LEFT	2	41349	41349	41349	41349
3	FEMALE HINGE LONG LEFT	2	41352	41352	41352	41352
4	PLEXIGLASS DOOR	2	61033	61033	61033	61033
5	DROP PANEL	1	49210	49210	49210	49210
6	GLIDE	4	47328	47328	47328	47328
7	CRUTCH TIP	4	49123	49123	49123	49123
8	OLD MAID PAN	1	49100	49100	49100	49100
9	LEAD-IN CORD	1	22038	22038	42369	42369
10	STRAIN RELIEF	1	76026	76026	76026	76026
11	MALE HINGE SHORT RIGHT	2	41350	41350	41350	41350
12	FEMALE HINGE LONG RIGHT	2	41351	41351	41351	41351
13	KNOB LID LIFT	3	47120	47120	47120	47120
14	TEE BOLT	2	75267	75267	75267	75267

Cabinet Breakdown - Interior



Item	Part Description	Qty.	Part Number			
			2488	2489	2488EX	2489EX
1	CORN PAN	1	49211	49211	49211	49211
2	GLASS RETAIN STRIP, FRONT	1	61038	61038	61038	61038
3	GLASS RETAIN STRIP, REAR	2	61037	61037	61037	61037
4	GLASS STRIP	1	61039	61039	61039	61039
5	GLASS STRIP COVER	1	61040	61040	61040	61040
6	HEAT ELEMENT	1	40031	40031	40113	40113
7	STRIP HEATER BRACKET	1	49425	49425	49425	49425
8	OLD MAID PAN	1	49100	49100	49100	49100
9	WIRING GUARD	1	49201	49201	49201	49201



Cabinet Breakdown - Interior

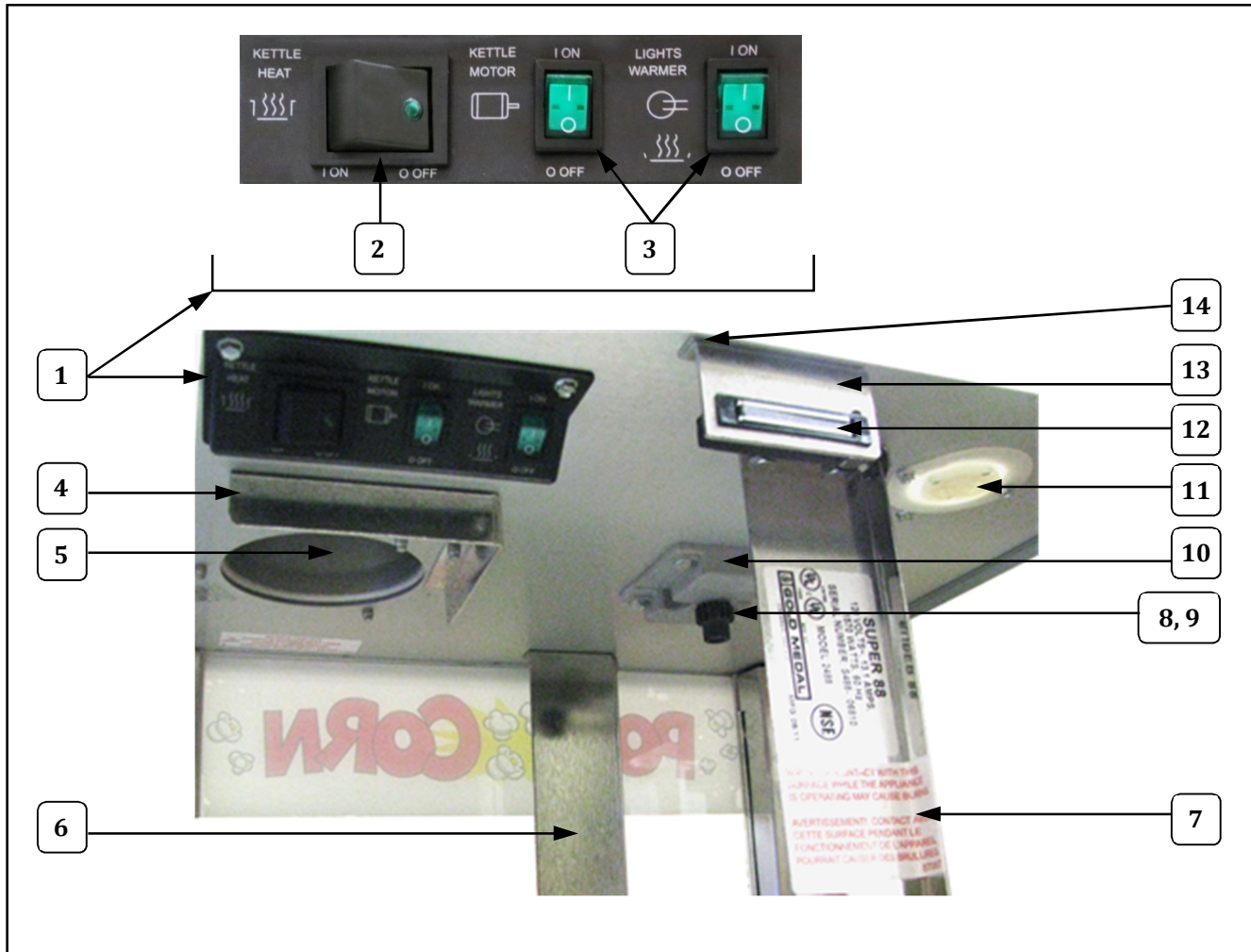

Item	Part Description	Qty.	Part Number			
			2488	2489	2488EX	2489EX
1	SMALL SWITCH BOX	1	48501	48501	48501	48501
2	LIGHTED ROCKER SWITCH	1	42798	42798	42798	42798
3	DPST ROCKER SWITCH	2	42532	42532	42532	42532
4	LIGHT SHIELD ANGLE	1	47799	47799		
5	65W REFLECTOR FLOOD - Light Bulb	1	41671	41671		
	75W HALOGEN FLOOD 240V-Light Bulb	1			41979EX	41979EX
6	REAR HANGER ARM	1	61050	61050	61050	61050
7	FRONT HANGER ARM	1	61049	61049	61049	61049
8	SPUR GEAR	1	47060	47060	47060	47060
9	SET SCREW 10-32 X 3/16	1	41742	41742	41742	41742
10	GEAR BLOCK ASSEMBLY	1	67194NM	67194NM	67194NM	67194NM
11	KETTLE RECPT	1	49330	49330	49330	49330
12	MAGNETIC CATCH	1	47561	47561	47561	47561
13	MAGNETIC CATCH MT BRKT	1	77089	77089	77089	77089
14	MAGNETIC BRACKET SHIM	1	38527	38527	38527	38527



Dome Interior - Electrical Breakdown

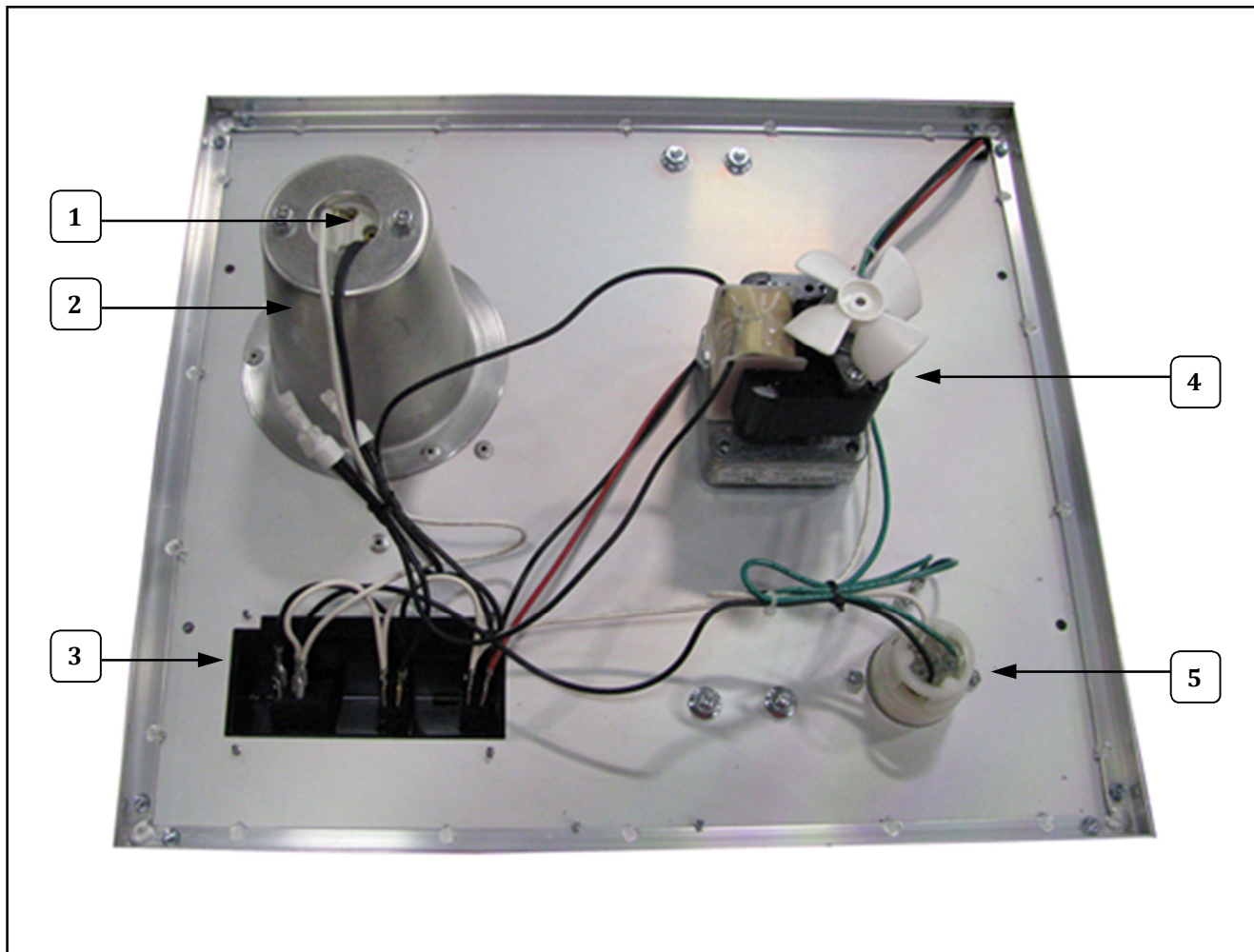

Item	Part Description	Qty.	Part Number			
			2488	2489	2488EX	2489EX
1	LAMP HOLDER	1	47047	47047	47047	47047
2	LIGHT SHIELD CONICAL	1	49480	49480	49584	49584
3	SMALL SWITCH BOX	1	48501	48501	48501	48501
4	KETTLE DRIVE MOTOR	1	47038	47038	47067	47067
5	KETTLE RECPT	1	49330	49330	49330	49330

Dome Lighting Breakdown – Model 2489 and 2489EX

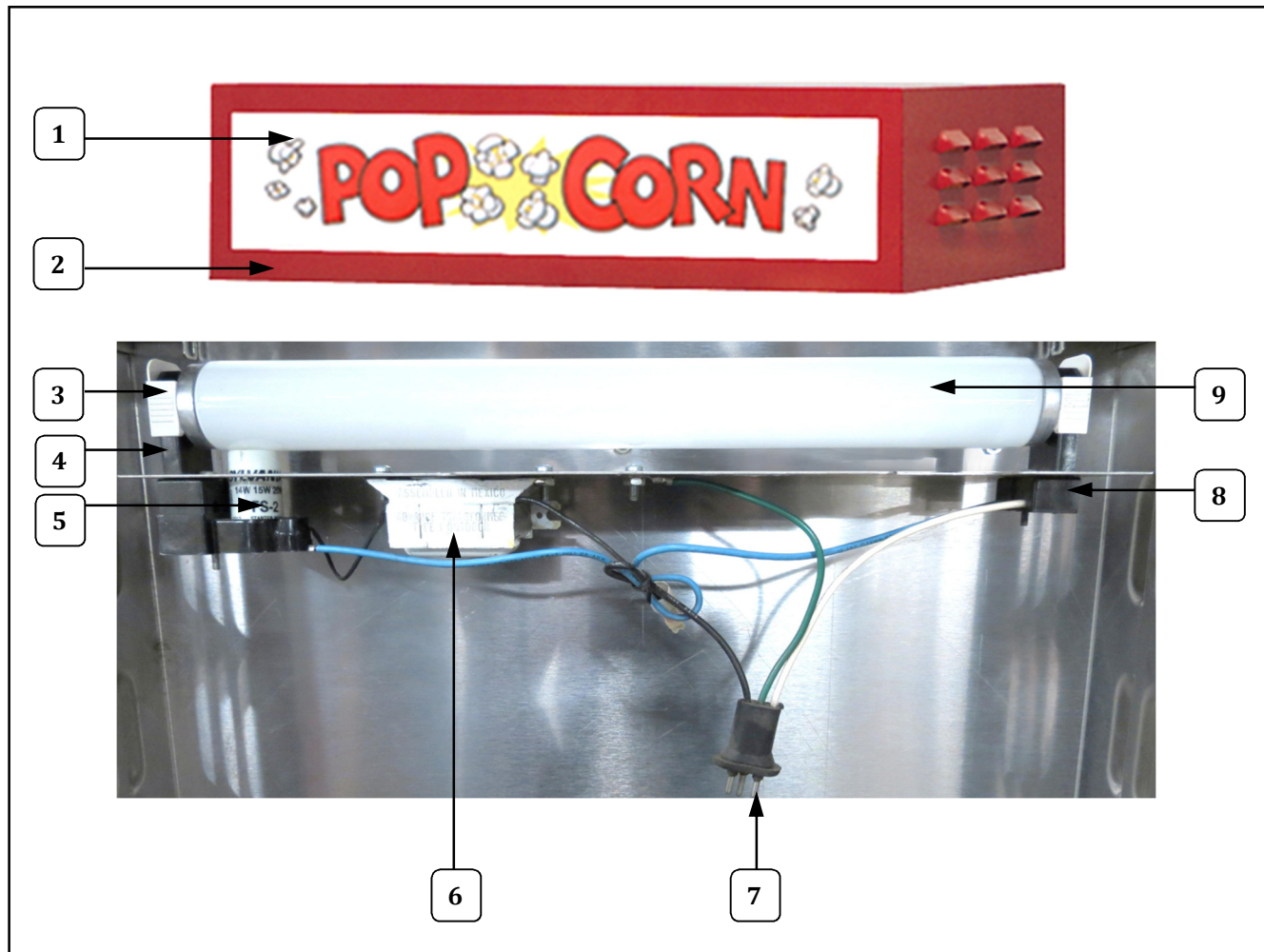

Item	Part Description	Qty.	Part Number	
			2489	2489EX
1	POPCORN SIGN	1	49575	49575
2	DOMES RED	1	59065	59065
3	FLUORESCENT TUBE LOCK	2	12502	12502
4	LIGHT TUBE HOLDER STARTER	1	41021	41021
5	LIGHT STARTER	1	41023	41023
6	LIGHT BALLAST	1	41022	41722
7	MOLDED PLUG	1	47726	47726
8	LIGHT TUBE HOLDER	1	41020	41020
9	LIGHT TUBE	1	41057	41057



Accessories



Item	Part Description	Qty.	Part Number			
			2488	2489	2488EX	2489EX
1	MEASURE ONE CUP	1	47147	47147	47147	47147
2	MEASURE 6.5CC (Flavacol Cup)	1	47678	47678	47678	47678
3	OIL MEASURE (1/3 CUP)	1	47150	47150	47150	47150
4	STAMPED ALUMINUM SCOOP	1	2071	2071	2071	2071



WARRANTY

Gold Medal Products Co. warrants to the original purchaser each item of its manufacture to be free of defects in workmanship and material under normal use and service. Gold Medal Products Co.'s obligation under this warranty is limited solely to repairing or replacing parts, f.o.b. Cincinnati, Ohio, which in its judgment are defective in workmanship or material and which are returned, freight prepaid, to its Cincinnati, Ohio factory or other designated point. Except for "Perishable Parts" on specific machines, the above warranty applies for a period of two (2) years from the date of original sale to the original purchaser of equipment when recommended operating instructions and maintenance procedures have been followed. These are packed with the machine. Parts warranty is two (2) years, labor is six (6) months.

THIS WARRANTY IS IN LIEU OF ALL OTHER WARRANTIES EXPRESSED OR IMPLIED, AND OF ALL OTHER OBLIGATIONS OR LIABILITIES ON OUR PART, INCLUDING THE IMPLIED WARRANTY OF MERCHANTABILITY. THERE ARE NO WARRANTIES WHICH EXTEND BEYOND THE DESCRIPTION ON THE FACE HEREOF. In no event shall Gold Medal Products Co. be liable for special, incidental or consequential damages. No claim under this warranty will be honored if the equipment covered has been misused, neglected, damaged in transit, or has been tampered with or changed in any way. No claim under this warranty shall be honored in the event that components in the unit at the time of the claim were not supplied or approved by Gold Medal Products Co. This warranty is effective only when electrical items have been properly attached to city utility lines only at proper voltages. This warranty is not transferable without the written consent of Gold Medal Products Co.

The term "Original Purchaser" as used in this warranty shall be deemed to mean that person, firm, association, or corporation who was billed by the GOLD MEDAL PRODUCTS CO., or their authorized distributor for the equipment.

THIS WARRANTY HAS NO EFFECT AND IS VOID UNLESS THE ORIGINAL PURCHASER FIRST CALLS GOLD MEDAL PRODUCTS CO. AT 1-800-543-0862 TO DISCUSS WITH OUR SERVICE REPRESENTATIVE THE EQUIPMENT PROBLEM, AND, IF NECESSARY, FOR INSTRUCTIONS CONCERNING THE REPAIR OR REPLACEMENT OF PARTS.

NOTE: This equipment is manufactured and sold for commercial use only.



GOLD MEDAL[®] PRODUCTS CO.

10700 Medallion Drive, Cincinnati, Ohio 45241-4807 USA

gmpopcorn.com

Phone: (800) 543-0862 Fax: (800) 542-1496
(513) 769-7676 (513) 769-8500